

Arboretum of Lackenbach Castle

The castle of Lackenbach is one of the earliest moated castles from the Renaissance period that exist in Burgenland today.

An important cultural and tourist landmark, the Esterházy castle is also a popular leisure destination and the venue for many different events. Since June 2000, its former economic section houses the exhibition "Der Natur auf der Spur" ("Following in the footsteps of nature"). The access zones to the castle of Lackenbach were restructured into two main areas from early 2006 until the end of 2007 in order to improve the castle's functionality as leisure destination and event venue.



© Rupert Steiner

3:0

landschaftsarchitektur



Main areas of Lackenbach Castle

Public area

Next to the main entrance, on the eastern side of Lackenbach castle, visitors are welcomed by a publicly accessible redesigned park. This park connects various functional areas: the visitor's car park, the adventure playground and the administration pavilion that was added recently and features a shop, a cafeteria and public sanitary facilities. This pavilion marks the main entrance to the secondary, semi-public area and attracts the attention of visitors coming from the car park.

Semi-public area

The former economic building now represents the new event section housing a museum, a concert hall and an event area that is available for rent. Along with the arboretum located in the inner courtyard, this section represents the main attraction of the entire facility.



3:0 landschaftsarchitektur

Reactivation of the park and arboretum

The special charm of the park consists in its function as a specially designed exhibition and as the center of the semi-accessible public areas of Lackenbach Castle. The park in front of the castle is a highlight of the permanent exhibition "Der Natur auf der Spur" ("In the footsteps of nature"). A masterpiece of nature, the park is a vivid part of the museum; its diversity of plants seine makes it a popular place of exploration for visitors. The primary trees (Pinus nigra, Sequoiadendron, Larix, Tilia, etc.) were made available to the public and continuously supplemented with other botanically valuable species (Parrotia persica, Betula nigra, Ilex aquifolium, Zelkova serrata, Maclura pomifera, Fagus sylvatica Syntelensis, etc.).

Thus, the arboretum once again fulfills its actual function as a tree cultivation facility serving educational purposes in the scope of the permanent exhibition.



3:0 landschaftsarchitektur

© Hertha Hurnaus



A water-resistant cover with a surface layer from basalt dissociates the arboretum from the surrounding buildings in a passe-partout-like manner and defines its rectangular shape. A 1.50 m wide and 150 m long object captures the arboretum as if it were in a picture frame. This “frame” is formed specifically to blend in or stand out from the local topography. Thus, it is possible for visitors to sit, walk, climb or play at various locations along its course. A water basin in front of the façade of the castles emphasizes the main entrance and makes a symbolic reference to the protective function of the moat that used to surround the castle.

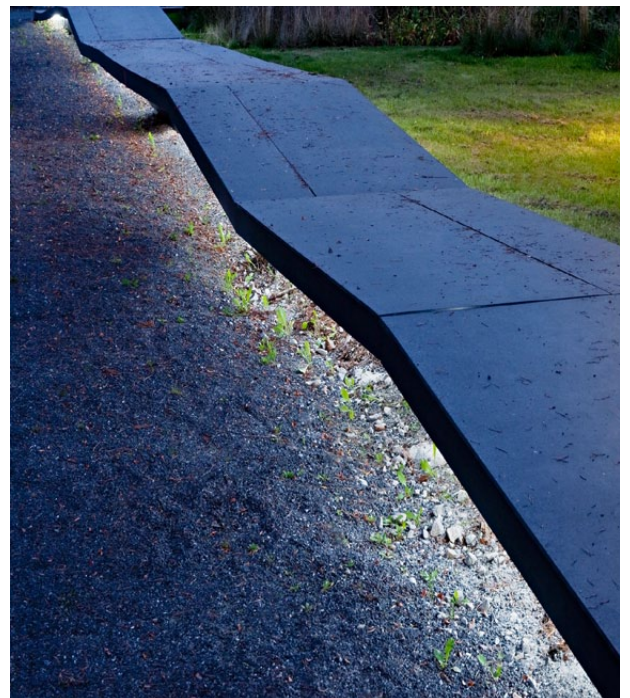

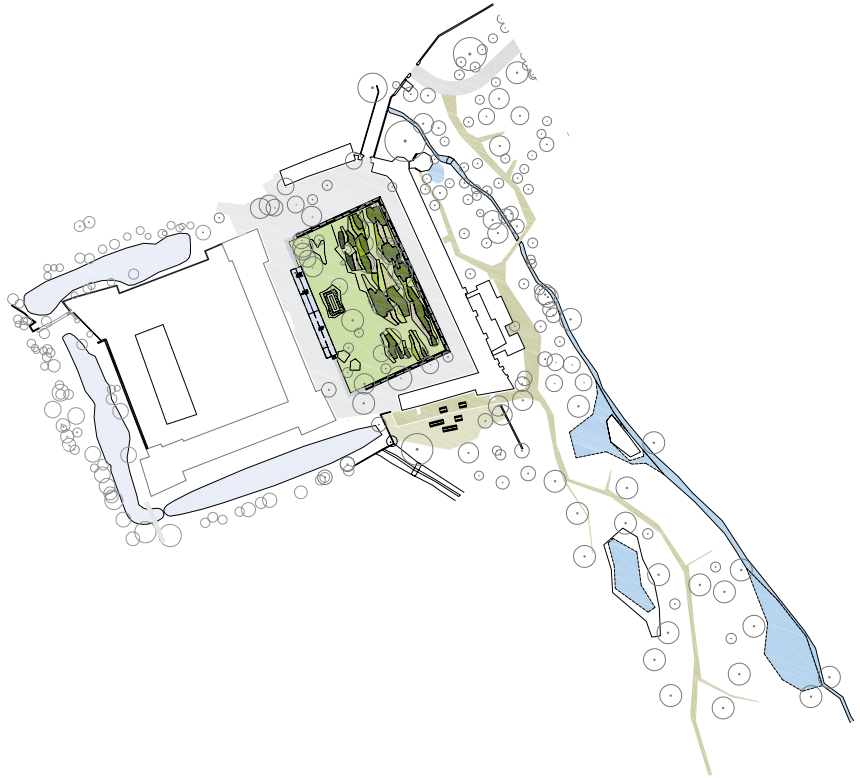

Arboretum of Lackenbach Castle

3:0 Landschaftsarchitektur
Nestroyplatz 1/1, 1020 Vienna
T +43 (0)1 969 06 62

Design: www.3zu0.com
Principal: Domänen Privatstiftung
Place: Lackenbach | Burgenland
Expansion: AllesWirdGut Architektur
Execution: Jakel Grünbau

Planning: 2006-2007
Construction: 2007
Completion: Winter 2007
Text: Gertraud Eibl
Photographers: Hertha Hurnaus, Rupert Steiner, 3:0



© Rupert Steiner